

18/117 Boyce Road Maroubra NSW

2 2 1

The Lifestyle:

With its oversized layout, huge entertainer's balcony and central location in the heart of Maroubra Junction, this chic security apartment is perfect for those looking for convenience. Set in The Matrix building and featuring easy level lift access from secure parking and the entry foyer, it offers more than 130sqm of living space with a well-conceived layout incorporating two large bedrooms, two fully tiled bathrooms and stylish timber floorboards. With everything at your doorstep, it features direct lift access to a shopping centre, cafes, restaurants and only minutes to the beach.

Property Features Include:

- Expansive open living and dining areas flowing onto a large leafy balcony
- Two fully tiled modern bathrooms and the second

View : <https://www.agentsandco.com.au/lease/nsw/eastern-suburbs/maroubra/residential/apartment/6765800>

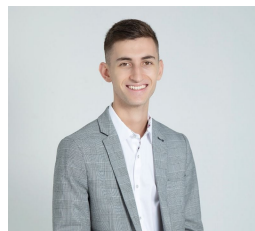

Anthony Schembri
02 9314 2100



Car Space
2.5 x 5.5

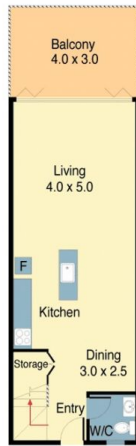

Ground Floor



First Floor