



8 Ermington Street BOTANY NSW

5 3 2

One of Botany's finest homes, this contemporary residence impresses with its palatial interiors and luxurious finishes. This family home offers stylish, low maintenance interiors with a multitude of living space. It holds a tranquil position a stroll from parks and cafes, easy access to Sydney CBD while Westfield Eastgardens is only minutes away.

Type : House

View : <https://www.agentsandco.com.au/sale/nsw/easter-n-suburbs/botany/residential/house/6767565>

Features:

- Spacious open plan living dining area, plus separate living at the front of the home
- Gourmet kitchen with mirror splash back, breakfast bar, stainless steel appliances
- Glass staircase leads to upper level boasting four bedrooms with built in wardrobes

[For full version visit the website](#)



GROUND FLOOR

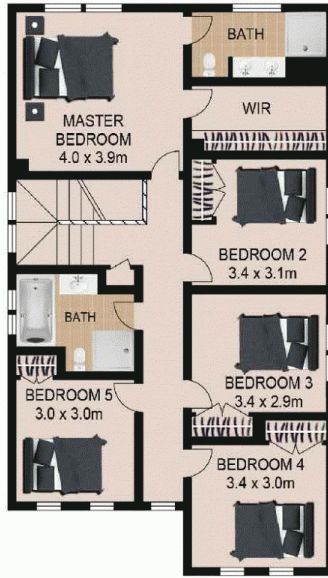

FIRST FLOOR



**SITE PLAN
(NOT TO SCALE)**

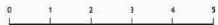

SCALE (METRES)

PLANS SHOWN ONLY INDICATIVE OF LAYOUT. DIMENSIONS ARE APPROXIMATE.
Ref. No: 71146

8 ERMINGTON STREET



BOTANY