



2 Dewsbury Street BOTANY NSW

4 2 2

About The Home:

- Generous living/dining area flows to outdoor entertaining
- North facing easy-care garden, kids cubby house & fish pond
- Renovated family sized gas kitchen w/stainless steel appliance
- Four large bedrooms w/built-ins/wir, study/office with CCTV
- Well-presented main bathroom with potential to personalise
- 2nd Living area/teenage retreat with brand new bathroom
- External laundry with additional w/c, under stair storageroom
- High ornate ceilings, air conditioning, timber floors throughout
- 4 Car driveway - 3 undercover car spaces, lock up

Land Size : 328 sqm

View : <https://www.agentsandco.com.au/sale/nsw/eastern-suburbs/botany/residential/house/6767694>



GROUND LEVEL

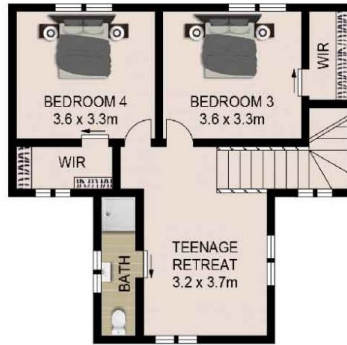

LEVEL ONE



SITE PLAN
(NOT TO SCALE)



All information contained herein is gathered from sources we deem to be reliable. However we cannot guarantee its accuracy and interested parties should rely on their own enquiries. Ref. No: 87072.

2 DEWSBURY STREET



BOTANY