



35/21-23 Myrtle Street BOTANY NSW

3 2 2

About the Home;

- * Sunlit spilt level apartment with open plan kitchen & living
- * Modern Gas kitchen with stone benchtops and island breakfast bar
- * Living area opens to covered entertainers balcony with leafy outlook
- * Three spacious bedrooms with built-in robes and balcony of master
- * Two chic bathrooms floor to ceiling tiles and additional powder room
- * Two secure car spaces & Intercom access through modern foyer to level lift access

The Lifestyle;

Building Size : 17 sqm

View : <https://www.agentsandco.com.au/sale/nsw/eastern-suburbs/botany/residential/apartment/6767752>



Natalie Vega
02 9314 2100



UPPER LEVEL

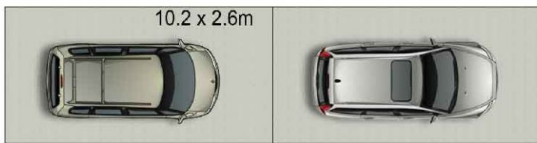

BASEMENT

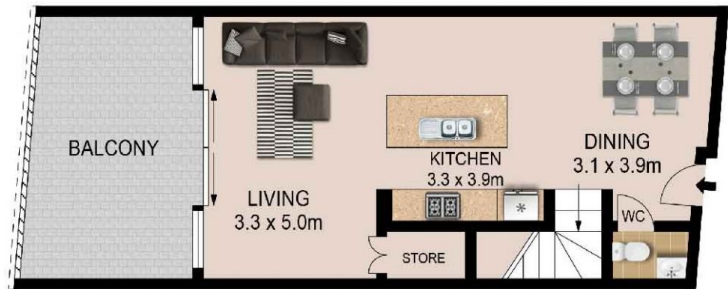

LEVEL THREE



All information contained herein is gathered from sources we deem to be reliable. However we cannot guarantee its accuracy and interested parties should rely on their own enquiries. Ref. No: 91629



35/21 MYRTLE STREET

BOTANY